



HEXAGONE  
MANUFACTURE



**Quick**  
vac'



HEXAGONE  
MANUFACTURE

[www.myhexagone.com](http://www.myhexagone.com) • [info@myhexagone.com](mailto:info@myhexagone.com) • Tél. +33 1 34 34 11 55

# SUMMARY

1. Introduction	4
2. Safety rules	5
3. How to install your pool vacuum cleaner Quick Vac?	6
A. Unpacking	6
B. Installing the battery or the electric box	7
4. How to use your pool vacuum cleaner Quick Vac?	8
A. Pool entry	8
B. Start up	8
C. Pool exit	9
5. Cleaning and maintenance	10
A. Cleaning of filter	10
B. Cleaning of the Quick Vac	10
C. Preventive maintenance	10
D. Charging the battery	11
6. Usage tips	12
7. Your warranty	13
A. Conditions	13
B. Duration of the guarantee	14
C. Purpose of the warranty	14
D. Transport Damage	14
E. Compliance	14
F. Special conditions	15
8. Spare parts and technical data	16
A. The vacuum cleaner	16
B. The trolley and its mounting	17
Conditions Générales de Vente Hexagone Manufacture S.A.S.	20

With this product you accept in a tacit and irrevocable manner our general conditions of sale. Photos in this technical manual are non-contractual.

**In order to ensure your safety and the validity of your guarantee, please read carefully and follow to the letter these instructions.**

The manual vacuum cleaner QUICK VAC is the professional device that must be used only by the qualified pool technicians.

The manual vacuum cleaner QUICK VAC is designed for regular maintenance of your pool. It does not replace the filtration system and is used only to suck up impurities in the bottom of the pool.

It should only be used with equipment recommended by the manufacturer. Any other use is incorrect.

The manufacturer's instructions for use, maintenance and repairs must be strictly adhered to.

This technical manual explains how to install, handle and maintain your manual vacuum cleaner QUICK VAC .

We strongly recommend that you:

- read this technical manual carefully by following the installation and operating instructions very precisely step by step to use your manual vacuum cleaner QUICK VAC in the best conditions;
- keep this technical manual for the entire life of the product. It might be useful. If you have any questions regarding the installation and use of your manual vacuum cleaner QUICK VAC, please call +33 1 34 34 11 55.

## 2. Safety rules

### Your safety:

Your vacuum cleaner QUICK VAC has been manufactured in accordance with the highest standards.

To use your equipment safely, observe the following:

- Keep the power supply unit far from the pool so as to prevent any falls.
- In order to avoid any risk of electric shock, never open the electronic control box. Call a qualified technician.
- Never attempt to repair the power cable. Contact the seller to replace it with the original spare part to avoid any danger.



### **WARNING!**

- **Keep the cleaner out of the reach of children.**
- **Place the trolley so that the cleaner can reach the furthest corner of the pool.**
- **Never let anybody enter the swimming pool during cleaning.**
- **Never put the trolley into the water, only the cleaner has to go into the water.**
- **Avoid working under direct sunlight; place the electric box out of direct sunlight.**
- **To avoid any electrical risk, never open the box yourself. Ask for a qualified person.**
- **Never pull on the cable.**
- **Cleaner for industrial purpose only and to be operated by qualified personal.**
- **Operators must keep their hands away from pump turbine while the vacuum is connected.**

## 3. How to install your pool vacuum cleaner Quick Vac?

### A. Unpacking

Unpack the unit by taking the necessary precautions. Do not use sharp tools (cutter, knife ...)

Check all items for damage from delivery. If damage is caused from the delivery please make a note on the delivery slip.

Only the recipient can file a claim with the carrier, you have 48 hours to do so by registered letter with acknowledgment of receipt. Also please notify us as soon as possible of the damage.

If your device is not in perfect condition, or if it does not work, notify your dealer immediately and do not try to operate without advice from a qualified or approved representative.

We recommend keeping the packaging and the original materials, they will be used for further transportation.

#### The Packaging must contain:

- the Quick Vac with its cable and its filter
- its transport trolley (follow enclosed instructions for assembly)
- a pocket with at least the user manual and the bolts for the trolley.

Depending on your buying option your device will be also equipped with:

- Option without power supply
  - One empty battery box
- Battery option
  - One empty battery box
  - One battery
  - One charger for battery and a set of lugs (+ and -)
- Option with power supply
  - An electrical box for network connection

### B. Battery connection

Install lugs on the battery terminals. Take care of polarity - lug + must be installed on the + terminal of the battery and connected to the red wire - pod - must be installed on the terminal - battery and connected to the black wire



#### **CAUTION!**

**Serious damage can be caused to the device if it is run out of the water, resulting in immediate void of the warranty.**

### 3. How to install your pool vacuum cleaner Quick Vac?

#### A. Installing the battery or the electrical box

**We remind you that the supply of the battery is to be at your expense or has been agreed upon the purchase of your device.**

Install the lugs on the battery terminals. Take care of polarity:

- the lug + must be installed on the + terminal of the battery and connected to the red wire;
- the lug - must be installed on the terminal - battery and connected to the black wire.

In the case of a device supplied with electric box, the last one is portable and therefore you are free to place it where you want respecting the safety distances of the standards in force.

Moreover, it is your responsibility not to bring it into the water.



**CAUTION!**

**Serious damage can be caused to the device if it is started out of the water, which leads to the immediate removal of the manufacturer's warranty.**

## 4. How to use your pool vacuum cleaner Quick Vac?

### A. Pool entry

- The trolley and the power box should be placed so that the robot can reach all corners of the pool;
- Be sure to unroll the entire self-floating cable at the edge of the pool, avoiding loops, before entering the unit into the water.
- Install a telescopic handle (adapted to the dimensions of the pool) on the bracket at the rear of the vacuum, then clip into place (you hear a «click» indicating that the handle is in place). This will allow you to guide the QUIK VAC during cleaning operations.
- Immerse the cable and the vacuum cleaner in the water, taking care to position the vacuum cleaner on its wheels. For this operation use the side handle provided for this purpose.



### CAUTION!

**Never turn the QUICK VAC out of the water, it may damage the pump and void your warranty.**

### B. Start up

Immerse the device first.

Connect the plug to the base of the power supply box, the pump starts immediately. You can then start to clean your pool.

### In case of electrical cabinet:

Make sure the power button is OFF before connecting the AC outlet. You can then connect the power outlet.

Then immerse the device, plug in the device and press the switch button to turn it ON. You can then start cleaning.

## 4. How to use your pool vacuum cleaner Quick Vac?

### A. Pool exit

Once the pool is clean at your convenience please follow the following steps:

- Bring the vacuum cleaner back to you by pulling the telescopic handle;
- Unplug the plug and wait a few moments for the check valve closes and the collected dirt remains trapped. Or if you have a **power supply box**, press the switch to the OFF position and unplug the box plug.
- Grasp the handle and pull it to extract the vacuum from the water, when it comes to the surface, grasp the side handle to pull the QUICK VAC out of the water.
- Position the Quick Vac on the trolley, proceed with cleaning the filter (see next paragraph),
- Store the cable by wrapping it on the arms provided for this purpose on the trolley. It is advisable to wind the cable starting with the part near the vacuum and ending with the plug, this precaution allows any loops to be discarded by themselves.

**In case of electrical box**, please store it away from the weather



#### **CAUTION!**

**Never pull the Quick Vac out of water by the cable.**



## 5. Cleaning and maintenance

### A - Cleaning of filter



**IMPORTANT!**

**The filter bag must be cleaned after each use.**

- Remove the filter from the Quick Vac.
- Put the bag upside down to empty the any largest debris
- Wash the filter under a tap or use a hose to spray.
- Put the filter back on the Quick Vac for storage



**ECOLOGICAL IDEA:**

**Prefer cleaning in a bucket of water, 15 or 20L of water should be enough.**

**Note:**

We recommend changing the filter bag regularly for the assurance of optimum cleaning.



**IMPORTANT!**

**Never operate the vacuum cleaner if the filter is damaged or the elastic has relaxed.**

### B - Cleaning of the Quick Vac

The submersible part should be cleaned with clean water and you should check and possibly remove debris caught in the propeller.

No mechanical parts require any external lubrication or maintenance.

### C - Preventive maintenance



**IMPORTANT!**

**All the cleaning and inspection must be carried out with the cable unplugged.**

## 5. Cleaning and maintenance

To ensure the efficiency of your QUICK VAC, it is important to check the below every week:

- The state of the turbine, check there is no debris in the propeller, you can remove turbine by unscrewing its locating block. Be careful not to lose the turbine pin.
- Check filter and elastic retainer inside the filter.
- Inspect the swivel wheels, make sure that nothing prevents their movement.
- Unroll the cable at the edge of the pool to make sure that it is not twisted and form loops.
- Finally, check the general appearance of the vacuum cleaner, screws, the pressure of the tires of the trolley, the state of the filter, possible impacts on the body...
- Check the condition of the check valve.
- Check levels of distilled water in the compartments of the battery, top up if necessary.



**Keeping your Quick Vac in perfect condition is a guarantee of its longevity.**

### **D - Charging the battery**

The battery that we advise is a battery 12 VDC 32A. It allows you 3 hours of battery life. Charge as soon as you notice a decline in power. To increase the battery life we recommend you do not let it fully discharge and ensure full charge each time.



#### **CAUTION!**

**Do not use a charger larger than 6 amp. Charged often and slowly, a battery will last longer.**

**The battery contains sulfuric acid which can cause severe burns. Avoid contact with eyes or skin.**

**The charge of the battery can release more or less dangerous gas emissions.**

**Take care to charge the battery in a ventilated room free from flame.**



### **CAUTION!**

- **Use your vacuum as often as possible: you will enjoy a pool which is always clean and there will be less debris in your filter each time.**
- **Never put the cleaner in water with a temperature below 10 °C or above 35 °C.**
- **Never use the vacuum cleaner in water with a salinity of  $\geq 4$  mg / l, or water with sulfur content.**
- **Store the cleaner in a well ventilated room free from frost, chemicals and acids.**

## 7. Your warranty

These conditions correspond to the French laws in force at the date of printing.

### **A - Conditions**

We guarantee that all materials are technically sound and free of defects of materials and manufacture and that they are consistent with the state of the art and techniques at the time of marketing. Subsequent technological modifications applied to our products due to technological progress cannot give rise to any intervention on our part.

The warranty is limited to the repair or replacement of the equipment if a compliance defect is recognised. The choice of the solution is at our discretion given that any application of the warranty could not exceed the resulting direct prejudice suffered and cannot lead to unreasonable costs to the dealer or the manufacturer.

The warranty is cancelled as of right if the equipment has been worked upon by a third party who does not belong to our workshop or by a repairer not certified by us or if modifications have been applied without our written consent. The warranty is also cancelled as of right if the operation and maintenance does not comply with the operation manual supplied with the equipment at purchase time.

All legal warranties as described in section 1641 of the Civil Code are applicable. Any text that could become Law after the printing of the present guarantee and whose terms would be in the order of public interest would automatically apply even if they are different from the present conditions.

### **The following are excluded from the warranty:**

- Replacement of wear parts such as filter bags, swivel casters, battery ...
- Electrical damage caused by lightning or a bad electrical connection.
- Breakage due to shocks.
- Any failure relating to the replacement of parts by parts other than original parts.
- Problems arising as a result of non-compliance with the rules of the instructions for use.

Under no circumstances can the repair or replacement done under guarantee result in the extension or renewal of the duration of the guarantee of the equipment.

## 7. Your warranty

### **B - Duration of the guarantee**

The duration of the guarantee is fixed at 1 year from the billing date to the first user or 3 months + 1 year after delivery to the distributor subject to sending to the manufacturer of the invoice for the purchase of the device or 'a photocopy.

### **C - Purpose of the warranty**

During the warranty period defined above, any component that is recognized to be faulty will be repaired or replaced by a new component or one that is in good operating condition.

Subject to any French legal provisions of public order that could be put into effect after the publication of this warranty, the transport and labor costs will be the responsibility of the user. In the case of a return to our workshop, the two-way transport costs will be the responsibility of the user and the labor costs will be the responsibility of the manufacturer.

The immobilization and lost operation time of the equipment due to repairs cannot give rise to any benefit. In any case, the legal warranty of the seller continues to apply under section 4 of Decree n° 78-464 of the 24th of March 1978.

### **D - Transport damage**

The equipment is transported at the risk of the consignee. The latter is responsible for verifying that the equipment is in perfect condition before accepting delivery. We cannot be held responsible in this matter.

### **E - Compliance**

This equipment has been designed and manufactured according to the following standards:

- NF C15-100 - Very low power supply for security
- NF EN 50 081-1 and NF EN50 082-1st June 1992

Electromagnetic compatibility – Generic standard for emission / immunity - Part I : residential, commercial and light industry

- NF EN 50 082-1st June 1992

### **Additional information relative to CE certification:**

The manual pool cleaner QUICK VAC is certified CE according to the following guidelines:

- C.E.M. 89/336/CEE and 92/31/CEE
- Low voltage 73/23/CEE with which the equipment is compliant.

The product has been tested under normal conditions of use.

## 7. Your warranty

### **F - Special conditions**

We remind you that the guarantee is subject to certain conditions.

- It is your responsibility to keep unauthorized persons away from the vacuum cleaner, cable, trolley and power supply unit.
- No guarantee can be given in case of operation of the equipment in rain more or less important without the sensitive parts (power supply box, socket ..) are sheltered (under a tarpaulin allowing ventilation of the case or other suitable means of protection).
- No guarantee or compensation can be granted in the event of deterioration of your swimming pool or your establishment due to any modification of the whole vacuum cleaner, cable, trolley, box by a third without our written agreement or by a bad use equipment.
- No guarantee can be given for use under extreme operating conditions (prolonged exposure to the sun without protection, storage in a room containing chemicals, exposure to freezing, use in water at - 10 ° C...)



## 8. Spare parts and technical data

NUMERO D'ARTICLE.	NUMERO DE PIECE	QTE
1	AA0006N9C0 CHASSIS QUICK VAC EQUIPE SANS POMPE NI CLAPET	1
2	P00006N000 POMPE QUICK VAC A CONNECTEUR FOND PLAT	1
3	VD0003N000 ECROU DE FIXATION POMPE QUICK VAC	2
4	K00010N900 CHARIOT QUICK VAC BLANC	1
5	C0QV14N500 CABLE QUICK VAC GRIS 14m (A CONNECTEUR)	1
6	QW0004N000 BOITE POUR BATTERIE QV EQUIPEE PRISE 5 POINTS	1
7	JD0006N000 CLAPET ANTI RETOUR QUICK VAC STANDARD	1
8	QQ0010N000-22 TENDEUR QUICK VAC 22cm entre crochets	2

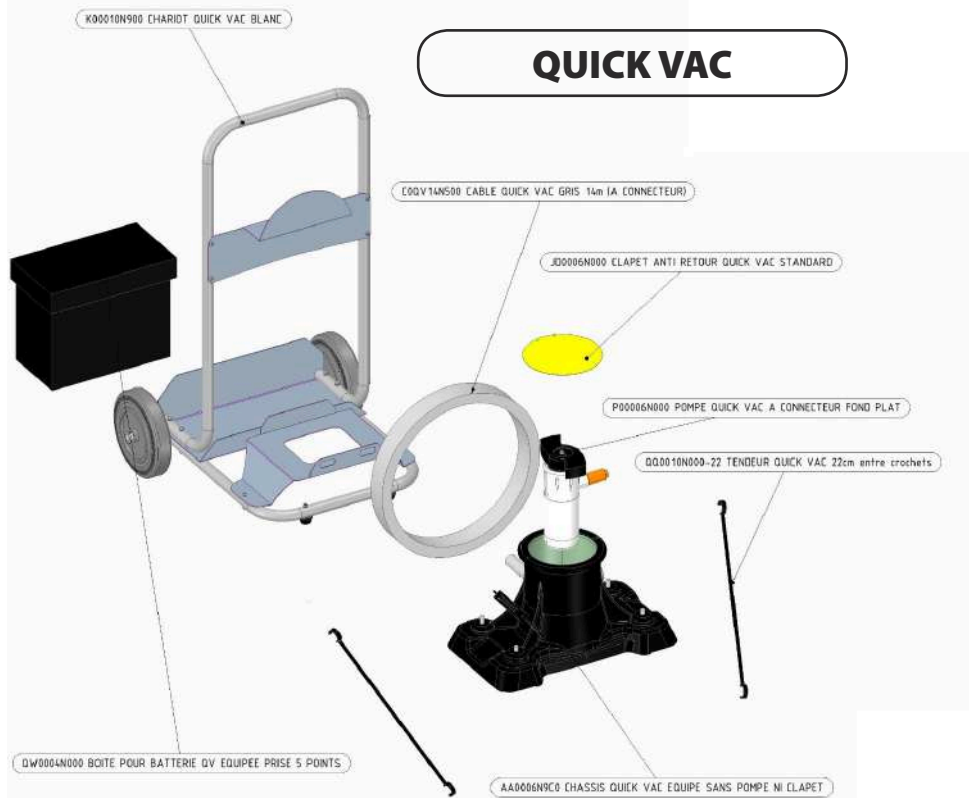

## 6. Spare parts and technical data

NUMERO D'ARTICLE. NUMERO DE PIECE

1	KA029BN000 BAS CHARIOT QUICK VAC
2	KA0300N000 PLATEAU CHARIOT QUICK VAC
3	KA0308N000 SUPPORT BATTERIE CHARIOT QV
4	KA0307N000 MONTANT CHARIOT QUICK VAC BLANC
5	KA0301N000 SUPPORT CABLE CHARIOT QUICK VAC
6	DD0041N000
7	KA0239N000
8	VEI4 Ecrou HU inox A2 M4
9	VT430 Vis TCL Torx inox A2 M4 L30
10	VEF4LUB
11	VR0004N000
12	VH540 Vis TH Inox A2 M5 L40
13	VRP5M
14	VEF5LUB
15	VH560 Vis TH Inox A2 M5 L50
16	VT535 Vis TCL Torx inox A2 M5 L35
17	VEB5



### TROLLEY

SIZE	LARGE CODE	DWG NO.	REV
A3		Z490HK0003N000 CHARIOT QUICK VAC BLANC	
SCALE	1:10	DD 2018-06-05	SHEET 1 of 2



# 6. Spare parts and technical data

## TROLLEY MOUNTING

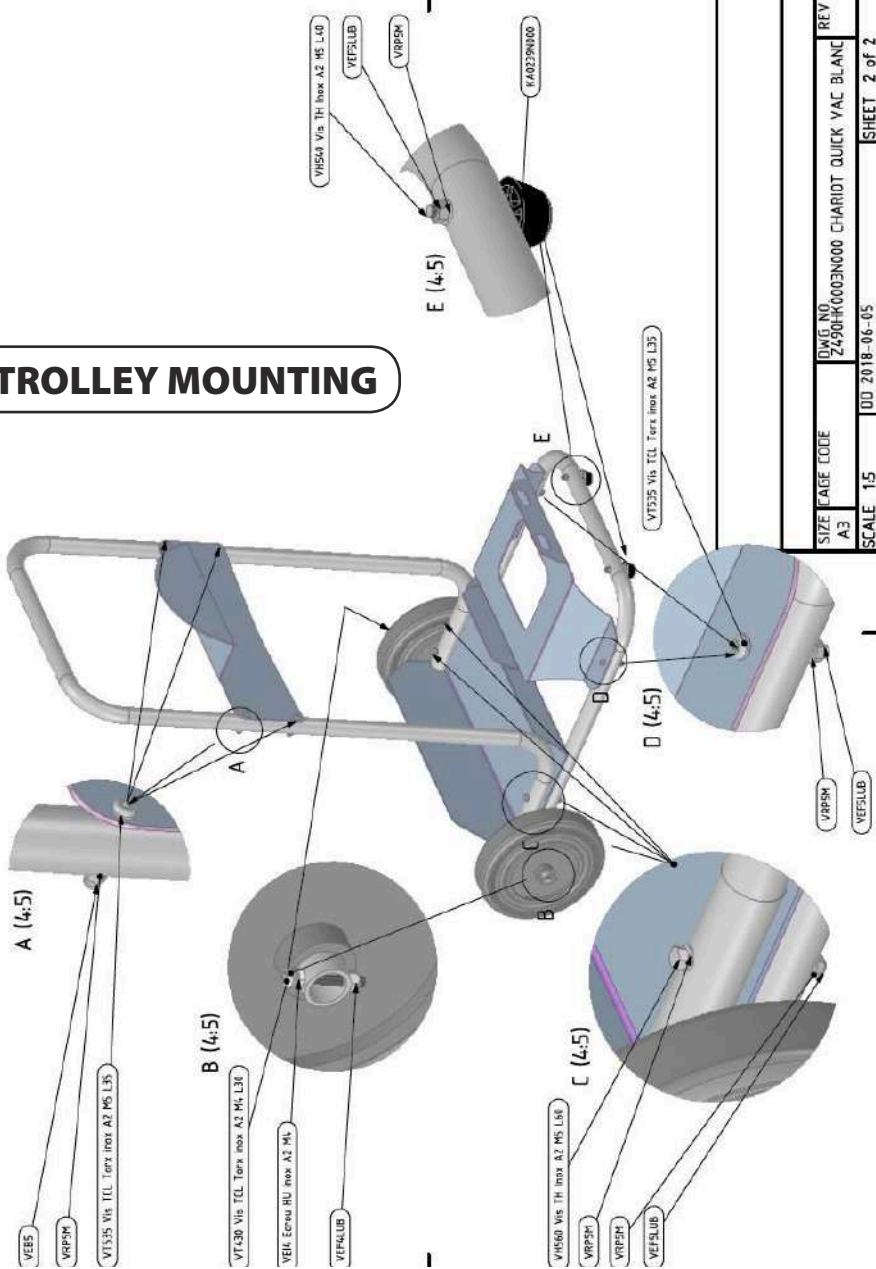

SIZE	A3	SCALE	1:5	DD	2018-06-05
DWG. NO.	Z4901K0003N000	CHARIOT	QUICK VAC BLANC	REV	
					SHEET 2 of 2

# General Conditions of Sale Hexagone Manufacture S.A.S.

## I GENERAL SALES PROVISIONS:

### I.1. APPLICATION AND ENFORCEABILITY OF THESE GENERAL CONDITIONS

These general conditions of sale (hereafter, "GCS") apply systematically to every buyer (hereafter "the Customer") with the current Hexagone Manufacture S.A.S. tariff, allowing him/her to place an order. As a result, the fact of placing an order implies full acceptance without reservation by the Customer of the GCS. No specific condition may, except in cases of formal and written acceptance from Hexagone Manufacture S.A.S., prevail over the GCS. In the absence of express acceptance, no contrary condition may be raised in objection with Hexagone Manufacture S.A.S. by the Customer, regardless of the time when it may have been brought to its knowledge. The fact that Hexagone Manufacture S.A.S. does not avail itself at any given moment of any one of these GCS may not be interpreted as a waiver of the right to avail itself of this at a later date. These GCS prevail over any Customer general conditions. These GCS apply to all countries.

### I.2. ORDER:

Order means any order relating to products which appear in our tariffs, and accepted by Hexagone Manufacture S.A.S.. Offers made by our agents or by telephone shall only constitute a commitment on our side after written confirmation from us. The Customer shall be deemed in agreement with the content of our confirmation if, within eight (8) days, he/she has not shared his/her observations with us in a written registered mail with acknowledgement of receipt. In the absence of any written observation, the order shall be deemed irrevocable. The order is non-transferrable and may not be transferred without the agreement of Hexagone Manufacture S.A.S..

### I.3. ORDER FULFILMENTS:

We reserve the right to make any modifications or improvements we deem necessary to our products at any moment, without this serving as grounds for a Customer to cancel an order, or requiring us to make any modifications or improvements to previously-delivered products.

### I.4. CANCELLATION OF ORDERS:

No order can be cancelled by our Customers without our prior and express agreement.

In any case where Hexagone Manufacture S.A.S. should accept the cancellation of an order, any deposit paid by the Customer shall be retained by us in compensation.

### I.5. DELIVERY:

Deliveries are carried out by freight forwarders either directly to the Customer or via a carrier.

#### 1.5.1. DELIVERY TIMES:

Delivery times as well as transportation times are determined on a case-by-case basis and are entirely indicative and without guarantee. Unless there is a contrary agreement, they shall never constitute a commitment on our side. Any delay to delivery shall not constitute grounds to terminate the order, or grounds for refunds, damages or interests, deductions, compensation, cancellation of the current order or the refusal of goods, as well as any kind of indemnity. If in cases of force majeure, and especially: fire, flood, discontinuation of product, machinery breakdown, war, riots, requisition, required reduction of imports, accident or manufacturing delay at our suppliers, delay to transportation of goods, as well as in cases of the occurrence of any event beyond our control which prevents the execution of the contract under normal conditions, whereby manufacture and/or delivery have been prevented or delayed, then our contractual obligations shall be suspended for as long as the case of force majeure exists, without any responsibility borne by Hexagone Manufacture S.A.S., even if a firm timescale has been confirmed. If the case of force majeure should continue for longer than forty-five (45) days, the more diligent party may, if it wishes, cancel the order affected by the case of force majeure without either of the parties laying claim to the payment of damages and interests.

#### 1.5.2. TRANSFER OF RISKS

The transfer to the Customer of risks of loss, theft or damage of goods sold, as well as the damages these may cause, shall be effective from the moment the courier takes possession of the order. The Customer shall, as a result, take out insurance covering these risks pertaining to the reception of goods for delivery by the courier.

#### 1.5.3. TRANSPORT

Unless otherwise stipulated, delivery shall be made by our accredited couriers with shipping costs billed to the Customer in addition to the price paid for the goods. Hexagone Manufacture S.A.S. cannot be held responsible for damage which occurs during transportation or unloading. Goods shall always travel at the Customer's risk, even in case of returns or despatches sent carriage paid or C.O.D. The Customer shall be responsible for checking that the goods are in good condition at the moment of delivery. They shall also check the quality, quantity and reference of goods, as well as that they match the original order. The Customer shall relay, where necessary, any concerns to the courier concerning missing and/or damaged goods, the type of damage and the extent thereof.

# General Conditions of Sale Hexagone Manufacture S.A.S.

These concerns must be communicated to the courier by the Customer by extra-judicial act or registered letter with acknowledgement of receipt within three (3) days, not including bank holidays, of the reception of said goods (article L133-3 of the French Code of commerce); one copy shall also be addressed to Hexagone Manufacture S.A.S.. All recourse shall be sought from the carrier. Where, in accordance with reasonable commercial standards, Hexagone Manufacture S.A.S. carries out additional transportation operations, such as loading, wrapping, securing, taking out an insurance policy, customs formalities etc. it shall only act as a representative of the consignee who retains their responsibility for the cost, risks and perils of such operations.

## I.6. COMPLAINTS AND RETURN OF GOODS

Without prejudice to claims made against the carrier by the Customer, such as those included in article 1.5.3., in the case of visible defects or missing products, any complaint, whatever its nature, relating to delivered products, shall only be accepted by Hexagone Manufacture S.A.S. if it is made in writing, by registered letter with acknowledgement of receipt, within fifteen (15) days following the delivery date. No goods may be returned without our express agreement and goods may only be returned if fit for resale. The Customer shall allow Hexagone Manufacture S.A.S. to verify any defects to allow for these to be remedied. He/she shall abstain from intervening themselves or from seeking intervention from a third party. The cost and risk of returns shall be borne by the Customer at all times. Any goods returned without our agreement shall be made available to the Customer and shall not lead to the establishment of an asset. Justified returns shall be subject to a replacement of the product as deemed most appropriate by Hexagone Manufacture S.A.S. in light of the Customer's needs or, where it is impossible for us to do so, a credit shall be made to the Customer after we have verified the quality of the returned machine, which shall exclude any compensation or damages and interests, deduction of the price of usable accessories, missing equipment and the cost of returning it to good working order. In cases where Hexagone Manufacture S.A.S. accepts the return of goods in conformity with the initial Customer requirements, the purchase price of said goods shall be paid to the Customer to a maximum of 75% of the billed value.

## I.7. PRICE AND PAYMENT

1.7.1. Prices, information and technical characteristics which can be found in our catalogues, tariffs, prospectus, technical specifications or other documents are indicative and cannot be deemed firm offers. These documents have no binding nature and can be modified at any moment and without prior notice. Our prices are expressed in Euros. Any taxes, duties or other contributions to be paid in accordance with French legislation and regulations, or those of an importing or transit country shall be borne by the Customer.

1.7.2. Our materials are always billed at the current tariff at the moment when the order is confirmed by Hexagone Manufacture S.A.S., and are less tax from the moment they depart our headquarters in Argenteuil, carriage and packaging not included.

1.7.3. A fixed sum of 21 € less tax on charges for all invoices of under 80 € less tax.

1.7.4. Our invoices are payable upon reception unless a different payment schedule is indicated on the invoice. Only the cashing of a paper instrument or cheque or the reception of a bank transfer shall be considered as valid payment under these GCS. In cases of payment by bills of exchange, the Customer is required to return the accepted paper instruments presented to them within a maximum of seven (7) days. Any amount including tax not paid within the allotted time shall give rise to a payment by the Customer of delay penalties fixed at 3% per month's delay, as well as a fixed rate of compensation to cover losses to our Company of a total of FORTY (40) EUROS. If the recovery costs are greater than the amount of said compensation, our Company shall then seek, with supporting documents, additional compensation (articles L.441-6 et D.441-5 of the code of commerce).

1.7.5. Recourse to our warranty obligation or any other demand of any kind that the Customer may make shall not allow him/her to in any case or under any pretext retain or delay payments owed to us, it is also expressly required that any delay or failure to pay should lead to the ceasing of recourse to our warranty and agreements.

1.7.6. Our sales are made fully and without exception at our Argenteuil headquarters, unless otherwise specified. Acceptance of our bills of exchange or payment by any other means shall not constitute either a renewal of or a derogation from this clause.

1.7.7. Failure to accept our drafts or payment default at the expiry of a bill of exchange or an invoice, and whatever the mode of payment or in cases of cessation of activity or cessation of funds, shall lead to the forfeiture of the term, requiring that all debts to us, including those not yet expired, be paid immediately. It shall also lead to the suspension or resolution of tenders, contracts and orders in progress, without possibility for the Customer to argue an unjustified refusal of sale, or claim any kind of compensation.

## 1.8. TRANSFER OF PROPERTY – OWNERSHIP RESERVE CLAUSE

Hexagone Manufacture S.A.S. reserves ownership of goods sold until effective payment of the full price for the main goods and accessories, even in cases of granting of payment terms.



# General Conditions of Sale Hexagone Manufacture S.A.S.

The Customer may in no case resell, pledge or grant a guarantee on the good delivered and not fully paid for. Payment default on any deadlines may lead to goods being reclaimed. Where reclaims are made, deposits already paid shall be retained by Hexagone Manufacture S.A.S. in compensation.

## **II WARRANTIES AND RESPONSIBILITIES:**

**II.1.** Goods must be verified by the Customer upon delivery, and any complaint, reservation or dispute relating to missing goods or apparent defects should be made within the provisions of article 1.6. In case of apparent defects, defective parts shall be replaced by Hexagone Manufacture S.A.S. or the goods replaced, subject to verification of the alleged defects. The Customer shall supply any documentation or elements which demonstrate the extent of observed defects. No complaints can be made by the Customer more than fifteen (15) days after the delivery of the goods. Indications of performance, speed, consumption power, weight etc. are only given on an indicative basis and without any commitments or guarantees on our side, any inaccuracies may in no case give rise to the termination of an order or a request for compensation.

**II.2.** Our products are aimed at professionals, and as such should only be handled by individuals who have received free training on the product offered to the Customer by Hexagone Manufacture S.A.S. or its accredited distributor. Our pool cleaners are guaranteed against any material and construction defects for a period of twenty-four (24) months from the delivery date and for up to 1200 hours of use. Our devices other than pool cleaners are guaranteed for 12 months from the delivery date. Our warranty only applies to products which have become the property of the Customer.

**II.3.** We shall no longer be bound by our warranty obligation in cases where the warranty terms on some aspects of our products are breached without our express agreement.

**II.4.** Our warranty is limited to the replacement or repair of parts which we deem defective, excluding any other damages.

**II.5.** Hexagone Manufacture S.A.S. accepts no responsibility in cases of operating losses, loss of time or of any other indirect loss caused by its goods. The Customer must seek a substitute to defective equipment. Furthermore, the client shall comment on the usage scope of the equipment in case of defects observed on the material by themselves or in the place of use or on their mode of use.

**II.6.** All standard new or exchanged spare parts are guaranteed for 6 months for a maximum 500 hours of use.

**II.7.** Warranty on consumable parts. Filters, brushes, crawlers, belts, cables, trolley tyres are considered consumable parts, whose warranty is limited to 6 months and a maximum of 300 hours of use.

**II.8.** Exclusions to warranty in the following cases:

damage and wearing resulting from a special, abnormal or otherwise application or assembly, carried out by the Customer or a third party without prior and written agreement from Hexagone Manufacture S.A.S.; use of our goods in conditions of use or performance which do not conform with the technical specifications of Hexagone Manufacture S.A.S., and more generally inappropriate or clumsy usage; damage or accident caused by the intervention of an employee of the Customer not trained to use the product or a company not accredited by Hexagone Manufacture S.A.S.; defects and/or damage to goods following maintenance not carried out in line with Hexagone Manufacture S.A.S. recommendations or failure to maintain, or irregular storage and/or conservation conditions by the Customer; whereby the Customer fails to notify Hexagone Manufacture S.A.S. in writing (specifically by fax or email) from the moment they observe the defect to the product under warranty and whereby they maintain in service a part or section of the defective product which may lead to further and more significant damage to the product or to the place of use. Malfunctioning as a result of normal wearing (e.g.: snapped belts, dead remote control batteries, bare brush-heads, etc...) or linked to problems with linings of and/or to specific shapes of pools which do not conform with the specification table required by Hexagone Manufacture S.A.S.; breakdown as a result of incorrect electrical installation, current fluctuations, poor connections or even the failure to observe by the Customer the electrical standards in force in the country of use; damage caused by external accidents: fall, transportation, fire, flood, melting, blackout, short-circuit, as well as accidents such as shocks, power-cuts, the introduction of foreign objects and/or liquids (acid, cleaning product, chlorine, water, tropical rainfall, etc...); where a third party or the Customer themselves has opened the electric control box and/or the engine or pump or gyroscope without our written agreement. The anti-corrosion warranty does not apply to sulphuric water or that without daily cleaning with stainless steel clear water.

As a result, Hexagone Manufacture S.A.S. shall not be held responsible for material damage or accidents suffered by individuals as a result of one of the cases listed above.

Shipping and returns costs incurred by the application of the warranty shall be borne by the Customer. We accept no responsibility for damage caused to property due to our products following an equipment failure or a construction defect to equipment sold.

# General Conditions of Sale Hexagone Manufacture S.A.S.

## PLEASE NOTE

The length of warranty for the defective equipment or part under guarantee shall be extended by a duration equal to the time spent in our servicing department where this is longer than a week. Outside of warranty repairs are subject to an estimated charge of 150 Euros less tax. This amount is only due if the Customer turns down repairs.

Any parts delivered by Hexagone Manufacture S.A.S. shall be invoiced at the moment of delivery.

In cases of warranty claims, said defective piece shall be returned to Hexagone Manufacture S.A.S. within a month maximum for assessment and work. Beyond this time, we can no longer accept it. Hexagone Manufacture S.A.S. shall in no case be held solely responsible for the cleanliness of pools. It is therefore recommended that the Customer always have access to a substitute for a defective machine.

If a technician from Hexagone Manufacture S.A.S. should establish that the breakdown is not covered by warranty, the technician may invoice for the uncovered problem in line with the current tariff.

Following testing of equipment under guarantee whose defect has not been found during servicing, the Customer shall be billed for the time spent looking for the defect.

Mode of intervention: you can contact the technical service by calling 0134341155 or any other Hexagone Manufacture S.A.S. agency. For work done under warranty, equipment or parts may only be sent to the following address: Hexagone Manufacture S.A.S., 34 rue du Perouzet, 95100 Argenteuil, France, quality service.

To request work under warranty, the Customer must fill in a sheet authorising the work, including the device's serial number, the in-service date, the number of the replacement part, as well as observations regarding the defect observed.

## III. INDUSTRIAL PROPERTY:

Any technical documents sent to our clients remain the exclusive property of Hexagone Manufacture S.A.S., the sole holder of intellectual property rights over these documents, and must be returned to us upon request. In accordance with laws currently in force, it is forbidden for customers to fully or partly reproduce our technical and commercial documents and to make any use of them which is liable to violate the industrial or intellectual property rights of our company. The Customer shall undertake not to divulge these to any third party.

## IV. INTERNET

We reserve the right to ask for removal of our products from sale on a website which does not respect our commercial policy in terms of price and trading conditions.

## V. TERMINATION CLAUSE

In cases where any one of the Customer obligations is not respected by the latter, sale may be terminated fully within rights, and goods returned to Hexagone Manufacture S.A.S. as it sees fit, without prejudice to any damages or interests which Hexagone Manufacture S.A.S. may assert to the Customer, within 48 hours after a formal notice which goes unanswered. In this case, Hexagone Manufacture S.A.S. is within its rights to seek a fixed rate of compensation of 15% of the total sale price from the Customer, as well as default interests and any legal fees incurred.

## VI. PROFESSIONAL WASTE ELECTRICAL AND ELECTRONIC EQUIPMENT (EEE)

In accordance with the provisions in articles R543-195 and R543-196 of the Environment Code modified by Decree n°2014-928 of the 19 August 2014, our Company has hereby joined the accredited eco-body LOXY at Parc d'Activité du Vert Galant 17 rue Antoine Balard – 95310 Saint-Ouen l'Aumône (RCS Pontoise 482.644.952) with a view to ensuring the collection and treatment of professional waste electrical and electronic equipment.

## VII. APPLICABLE LAW – ATTRIBUTION OF COMPETENCE

This contract is governed by French law. The application of the Vienna Convention on Contracts for the International Sale of Goods is specifically excluded. Any dispute relating to the forming, implementation or termination of contractual obligations between the parties which does not lead to amicable settlement shall be referred to the French courts. In case of any dispute with professionals and/or merchants, this shall be referred to the TRIBUNAL OF COMMERCE OF PONTOISE within whose area of jurisdiction Hexagone Manufacture S.A.S.'s headquarters is situated, whatever the conditions of sale and mode of payment accepted may be, even in cases of incidental claims, warranty appeal or of more than one respondent, Hexagone Manufacture S.A.S. reserves the right to refer the case to the competent local jurisdiction where the Customer's headquarters are situated.

## VIII. PARTIAL NULLITY

If one of the clauses or provisions of these GCS should be annulled or declared void by a definitive court ruling, such nullity or void nature shall be without prejudice to the other clauses and provisions, which shall continue to apply.

Information and photos in this technical manual are non-contractual and may be modified at any time and without prior notice by Hexagone.